

# Grinding

## EZW 180 I

### Powerful Angle Grinder Machine



**EIBENSTOCK**  
**POSITRON**

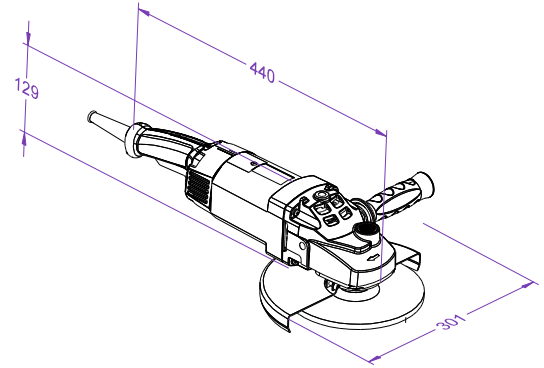

#### Use :

- Cutting and grinding general steel and other materials.
- Removing of screed seams, residual mud, plaster.
- Concrete, screed, tile adhesive, plaster, paint, coatings, carpet adhesive-with special grinding wheels (accessories).
- Working tight spots, for example under radiators, protrusions.
- Cutting metal with cutting disc.



#### Features:

- Powerful Motor
- Superb Service life
- Spindle lock - easy tool change
- For longer working hours powerful motor with 2300 watts.
- Well balanced design
- Auto Cutoff carbon brush.
- Excellent power to weight ratio.
- Light weight and short length for better ergonomics.
- 5 meter power cord

Sr. No.	Description	EZW 180 I
1	Input Supply Voltage (V) :	220 - 240
2	Motor Input (W) :	2300
3	Disc Ø (mm) :	max. 180
4	No. load Speed (min <sup>-1</sup> ) :	8500
5	Thread of work Spindle :	M14
6	Weight (kg) :	5.0

Eibenstock Positron Elektrowerk Pvt. Ltd.  
Plot No. 144/1,2,3, KATP, Tardal,  
Taluka- Hatkanangale,  
Dist. Kolhapur – 416 121,  
Maharashtra, (INDIA)

GERMAN ENGINEERING

मेड इन इंडिया

[www.ep-india.in](http://www.ep-india.in)

[www.facebook.com/EibenstockPositron](https://www.facebook.com/EibenstockPositron)

A partner  
company of  
The German  
Power Tool  
Manufacturer



**EIBENSTOCK**  
**Power Tools**